

TD33

Compact Intercom for Intuitive Calling, Enhanced Security, and Seamless Access



Overview

Verkada’s TD33 Video Intercom is a versatile and multifunctional device featuring video intercom, access control, and security camera capabilities, all in a sleek and durable form factor. The TD33 delivers excellent call quality across diverse environments. Callers can be seen clearly in nearly any type of lighting condition, and both callers and receivers can be audibly heard in highly-trafficked areas.

Organizations can simplify their entry experiences with native and third-party integrations to access control systems. The TD33 is also equipped with a card reader that is compatible with several credential types and technologies. The intercom camera also offers the full recording and analytics functionality of Verkada’s security cameras to boost visibility and security at entryways.

The TD33 is great for outdoor deployments. Its slim form factor makes it mountable on door mullions or other tight spaces, but a variety of mounting options and accessories facilitate easy installation on almost any facade.

Key features

All-in-one functionality

Combined video intercom, access control, and security camera functionality simplifies and secures the entire entry experience.

High-definition video

5MP camera resolution, Wide Dynamic Range, IR LEDs, and 130° FoV allow a clear visual of high-traffic entryways day and night.

HF, LF, NFC, BLE support

Built-in card reader supports many common high-frequency, low-frequency, NFC, and Bluetooth LE credentials.

Slim form factor

Sleek profile allows installation on narrow door frame mullions and other areas with limited space.

Sharp audio

A digital MEMS microphone and 80 dB speaker with advanced noise suppression and echo cancellation combine to deliver maximum audio clarity on every call.

Built for durability

IP65 and IK07 ratings ensure the intercom withstands strong impact and inclement weather.



TD33 Tech Specs

Power and rating

Power Consumption	44-57V, 10-350 mA	Power Input	IEEE 802.3af PoE
Connectivity	Ethernet: 10/100/1000Mbps RJ-45 cable connector for Network/PoE connection	Rating	IK07, IP65

General

Dimensions	Height: 229mm / 9.0in Width: 42mm / 1.7in Depth: 29mm / 1.1in	Operating Temperature	-40°C - 50°C / -40°F - 122°F
Weight	0.6kg / 1.3lb	Tamper Detection	Yes
Included Accessories	Surface mount plate, T10 screwdriver, mounting hardware kit	Separate Accessories	Angle mount box
Warranty	10 years	Onboard Storage	512GB
Inputs / Outputs	2x dry inputs 1x dry relay, 30VDC @ 1A (resistive load) 1x RS-485 port	Construction	Aluminum, steel, polycarbonate

Dimensions



Compliance and availability

Compliance & Safety	FCC Part 15B Class B, ICES-003 Class B, CE, UKCA, RCM, UL/IEC 62368-1, CSA NO22.2 62368-1, UL 294, ULC-60839-11-1 Outdoor	Availability	USA, CAN, UK, EU, AUS, NZ
--------------------------------	---	---------------------	---------------------------

Card reader compatibility

Controller Compatibility	Runs directly on TD33 intercom or via RS-485 connection to a standalone Verkada access controller	Low Frequency Card Compatibility	HID Prox II 26-Bit (H10301), 37-Bit Wiegand HID H10304, 37-Bit Wiegand HID H10302, HID 35-Bit Corporate 1000
High Frequency Card Compatibility	Verkada DESFire EV3, MiFare / DESFire NFC Card Serial Number	Mobile Credential Compatibility	Verkada Pass app, Apple Wallet, Android NFC



TD33 Tech Specs

General

Sensor Resolution	5MP (2688 x 1944)	Iris	Fixed
Lens Type	Fixed	Aperture	F2.0
Image Sensor	1/2.8" Progressive CMOS	Field of View	Horizontal: 130° Vertical: 100° Diagonal: 160°
IR Range	5m / 16ft in low light	Focal Length	2.12mm

Audio specifications

Audio Streaming	Two-way, full duplex with echo cancellation and noise suppression	Audio Input	1 omnidirectional digital MEMS microphone
Audio Output	2W speaker; 80dB SPL at 1m / 3.3ft		

Intercom software capabilities

Verkada Receivers	Verkada Pass app, Verkada Desk Station, Verkada Command	Phone System Receivers	SIP, VoIP, PSTN, Microsoft Teams
Remote Lock / Unlock	Yes	Call History Details	Call timeline, video recording, searchable transcript, people detection and search
Call Routing Features	Multiple user and receiver options, failover steps, automatic messages, schedulable call logic, routing to central call center	Insights at Scale	Annotated call events, AI-powered transcription search, reports, call flows, and dashboard analytics across intercoms and sites

Video security software capabilities

Alerts	Call triggered, call missed, SIP connection, device status, motion detection, people detection, vehicle detection, Person of Interest search, crowd detection	Streaming and Storage	Cloud backup, selectable storage location, timelapse, RTSP
People Analytics	People search, attribute search, face search, occupancy trends	Sharing and Privacy	Live Links, privacy regions, audit log
Vehicle Analytics	Vehicle search, attribute search	Incident Reporting	Archive clips, save to incident report



TD33 Inputs and Outputs

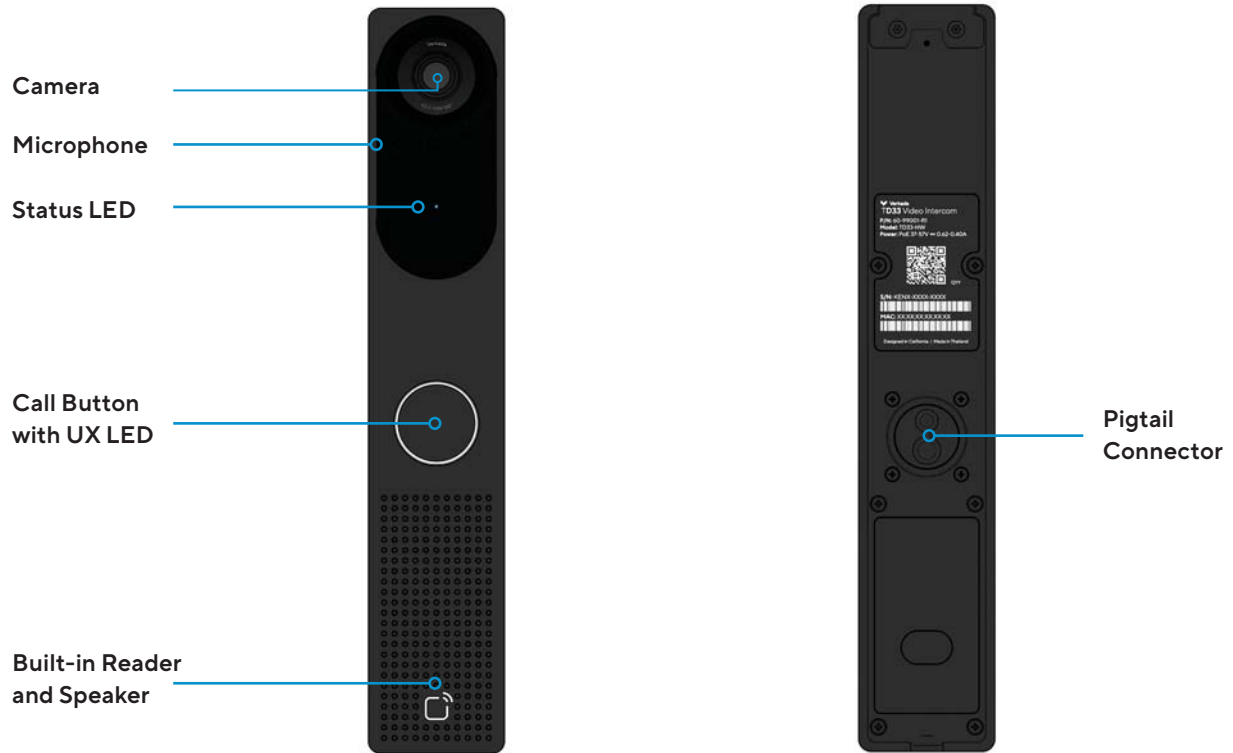

IO Function	Color Coding
NO	Brown
COM	Yellow
NC	Blue
RS-485 A-	White
RS-485 B+	Green
IN1	Purple
GND	Black
IN2	Orange
GND	Black
Earth_Gnd	Green w/ yellow stripe